

Instructions for use



Administering Nutropin AQ and Nutropin

NutropinAQ[®]
[somatropin (rDNA origin) injection]

Nutropin[®]
[somatropin (rDNA origin) for injection]

Genentech

This is a quick reference guide for use in preparing Nutropin AQ and Nutropin for injection with a syringe.

DO NOT RECONSTITUTE (MIX) THE DRUG, OR INJECT IT, UNTIL YOUR HEALTHCARE PROFESSIONAL HAS THOROUGHLY TRAINED YOU IN THE PROPER TECHNIQUES.

If your healthcare professional has prescribed **Nutropin**, it is supplied as a dry powder and must be reconstituted (mixed with a liquid) before it can be injected. Start on the next page with **RECONSTITUTING A NUTROPIN VIAL**.

If your healthcare professional has prescribed **Nutropin AQ**, start with **MEASURING THE DOSE** on page 4.

Start here if you are using Nutropin

RECONSTITUTING A NUTROPIN VIAL

Reconstitute the Nutropin vials **ONLY** with **Bacteriostatic Water for Injection, USP. PRESERVED WITH BENZYL ALCOHOL** provided in the carton.



1 Wash your hands thoroughly.



2 Remove the protective plastic cap from the top of both the diluent and Nutropin vials. Clean the rubber stopper on the top of **each** vial with an alcohol swab.



3 Remove the plastic needle guard and set it aside. Draw air into the syringe by pulling back on the plunger. The amount of air should be equal to the volume of diluent needed.



4 Slowly insert the needle into the vial of diluent and inject air into the vial.



5 Turn the diluent vial upside down with the syringe needle still in it and withdraw the diluent to the exact level needed.



6 Slowly insert the needle straight through the center of the rubber stopper of the Nutropin vial and discharge the diluent. Withdraw the needle.



7 Swirl the growth hormone vial with a gentle circular motion until the contents are completely dissolved. **Never shake the Nutropin vial after it has been reconstituted.**

Note: A diluent vial that you have opened and removed diluent from can be used for 14 days. The reconstituted vial of Nutropin cannot be used after 14 days and should be discarded.

Nutropin AQ[®]
[somatropin (rDNA origin) injection]

Nutropin[®]
[somatropin (rDNA origin) for injection]

Start here if you are using Nutropin AQ

MEASURING THE DOSE

Whenever a new vial of Nutropin AQ is opened or Nutropin is reconstituted, always mark the date on the vial. Nutropin AQ may not be used for more than 28 days after the first use. Nutropin may not be used for more than 14 days after reconstitution.

Nutropin AQ and Nutropin are both measured the same way. Before each use, ensure the Nutropin AQ or Nutropin solution is clear. Occasionally, after refrigeration, you may notice that small colorless particles of protein are present in the Nutropin AQ or Nutropin solution. This is not unusual for solutions containing proteins and does not indicate any decrease in potency of this product. Allow the vial to come to room temperature and gently swirl. If the solution is cloudy or hazy, do not inject it but return the vial of Nutropin AQ or Nutropin to your pharmacist or prescribing physician.



1 Wash your hands thoroughly.

2 Check the date on the Nutropin AQ or Nutropin vial to make sure it is not outdated.



3 Wipe the rubber stopper located on top of the vial with an alcohol swab.

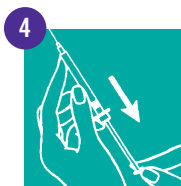

4 Remove the plastic needle guard and set it aside. Draw air into the syringe by pulling back on the plunger. The amount of air should be equal to the Nutropin AQ or Nutropin dose.



5 Slowly insert the needle straight through the center of the rubber stopper of the vial containing the Nutropin AQ or Nutropin solution.



6 Gently push the plunger to discharge the air into the vial.



7 Turn the vial upside down with the syringe needle still in it and slowly pull back on the plunger in a continuous motion until the correct amount of solution is in the syringe.

Turn the vial upside down with the syringe needle still in it and slowly pull back on the

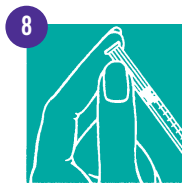

8 Remove the needle from the Nutropin AQ or Nutropin vial and give the injection immediately. If you need to set the syringe down while you prepare the injection site, replace the needle guard temporarily until you are ready to inject.

Remove the needle from the Nutropin AQ or Nutropin vial and give the injection immediately. If you need to set the syringe down while

Instructions for Nutropin AQ and Nutropin continued

SELECTING THE INJECTION SITE

Your healthcare professional will teach you how to locate appropriate injection sites. It is very important that you change the site of an injection each time you give the medication. Even if you develop a preference for one site, you should still change the injection site.

The following drawings show suggested injection sites on the body.



Upper arm



Thigh



Abdomen

Nutropin AQ[®]
[somatropin (rDNA origin) injection]

Nutropin[®]
[somatropin (rDNA origin) for injection]

GIVING THE MEDICATION

Your healthcare professional will provide you with training on how to give an injection. Needles and syringes should be used only once to ensure sterility of both the needle and the syringe. The following is a review of the steps involved in giving the medication:



Clean the injection site with an alcohol-saturated cotton ball or alcohol swab.



Double-check that the correct amount of Nutropin AQ or Nutropin solution is in the syringe. If you had replaced the needle guard while you prepared the injection site, remove it now. Hold the syringe the way you would hold a pencil.



Squeeze the skin between your thumb and index finger before and during the injection. Insert the needle into the skin at a 45° to 90° angle with a quick, firm motion.



Slowly (within a few seconds) inject the solution by gently pushing the plunger until the syringe is empty.



Withdraw the needle quickly, pulling it straight out, and apply pressure over the injection site with a dry gauze pad or cotton ball.

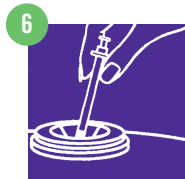

Dispose of the needles in an appropriate container. Keep out of reach of small children.

STORAGE

Nutropin AQ **must** be refrigerated, and cannot be used 28 days after the first use and should be discarded. **The Nutropin AQ vial MUST NOT BE FROZEN.**

Nutropin **must** be refrigerated before (powder form) and after reconstitution (liquid form). Reconstituted Nutropin cannot be used after 14 days and should be discarded. The unopened and opened vials of Bacteriostatic Water for Injection, USP (benzyl alcohol preserved), should also be refrigerated. Opened vials of Bacteriostatic Water for Injection cannot be kept indefinitely even if refrigerated. If you have questions about how long to keep open vials of Bacteriostatic Water, check with your healthcare professional or your pharmacist. **The Nutropin vial, after reconstitution, and the vial of Bacteriostatic Water for Injection, USP (benzyl alcohol preserved) MUST NOT BE FROZEN.**

Both Nutropin AQ and Nutropin should be refrigerated at 36° to 46° Fahrenheit (2° to 8° Centigrade).

For questions, call 1-866-NUTROPIN (1-866-688-7674), consult your healthcare professional, or visit nutropin.com.

Nutropin AQ and Nutropin are available in the US by prescription only.

Please see accompanying Nutropin AQ and Nutropin full prescribing information.

Nutropin AQ[®]
[somatropin (rDNA origin) injection]

Nutropin[®]
[somatropin (rDNA origin) for injection]

If you have questions, contact your healthcare professional. For additional information, call 1-866-NUTROPIN, or visit Nutropin.com.

Genentech
IN BUSINESS FOR LIFE

Nutropin AQ[®]
[somatropin (rDNA origin) injection]

Nutropin[®]
[somatropin (rDNA origin) for injection]